

Click Here to  
Request Quote

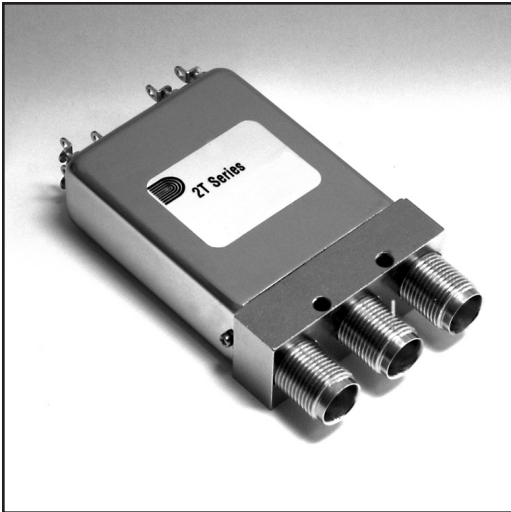

The **2T Series** features TNC connectors and a frequency range of DC to 10 GHz.

This series is available with fail-safe, latching self cut-off, or pulse latching functions.

<b>Weight (max.):</b>	5.5 oz
<b>RF Impedance:</b>	50 ohms nominal
<b>Operating Temperature:</b>	-25°C to +65°C ambient
<b>Operating Life:</b>	1,000,000 cycles min.
<b>Switching Sequence:</b>	Break Before Make

**SPECIFICATIONS**

Frequency	VSWR (max.)	Insertion Loss (dB max.)	Isolation (dB min.)
DC-4 GHz	1.20	0.20	80
4-10 GHz	1.60	0.60	60

Actuator Current (typical)	12Vdc	15 Vdc	24 Vdc	28Vdc
Fail-safe	325mA	255mA	160mA	125mA
Latching	200mA	155mA	100mA	95mA

\* If reduced coil current is required, please contact Factory.

Position	NO	NC	Latching
Switching Time - m Sec (Max)	20	50	20

**AVAILABLE OPTIONS**

OPTION 3 VOLTAGE	OPTION 4 ACTUATOR		OPTION 5 POLARITY
1 - 12 Vdc	<b>Fail-safe</b>		1 - Negative
2 - 28 Vdc	A - Standard	C - Indicators	2 - Positive
3 - 15 Vdc	B - Diodes	D - Diodes, Indicators	3 - Not Applicable
5 - Other	<b>Pulse Latching</b>		<b>OPTION 6 TERMINALS</b>
6 - 24 Vdc	Low Input Drivers with:	High Input Drivers with:	1 - Solder Terminals
7 - 5 Vdc	E - Diodes	EH - Diodes	3 - Other (Specify)
	F - Diodes, Indicators	FH - Diodes, Indicators	4 - Sub Miniature D-Shell Connector
	<b>Latching Self Cut-Off</b>		
	G - Diodes	H - Diodes, Indicators	
	Low Input Drivers with:	High Input Drivers with:	
	J - Diodes	JH - Diodes	
	K - Diodes, Indicators	KH - Diodes, Indicators	

**ADDITIONAL OPTIONS**

OPTION 7 STANDARD OPTIONS
1 - Moisture Seal
2 - High Temperature (125° C)
3 - Moisture Seal & High Temperature (125° C)

Please Note: Schematics may include optional Indicator Contacts. If your Actuator Option does not include Indicator Contacts, omit them from the schematic.

For "Additional Options" please contact Factory for part number

**2T**

- Option 2  
Series
- Option 3  
Voltage
- Option 4  
Actuator
- Option 5  
Polarity
- Option 6  
Terminals

**TOP VIEW**

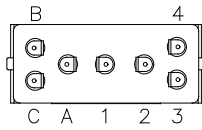

Actual markings will reflect terminal functions, not letter or number designation as shown above.

**DC TERMINAL FUNCTIONS**

PIN	FAILSAFE				LATCHING	
	A, C	B, D	E, EH, F, FH	G, H	J, JH, K, KH	T, U, V, W
1	N/A	N/A	N/A	N/A	+V SW	N/A
2	N/A	N/A	C RTN	C +/-	C RTN	C +/-
3	AV	AV-	L	AV 1-/+	L 1	PV 1-/+
4	AV	AV+	+V SW	AV 2-/+	L 2	PV 2-/+

**SCHEMATICS**

Pages 132-137						
	S1, S2	S3	S4	S5	S6	S8, S9

**INDICATORS**

PIN	A	B	C
	COM	1 or N/C	2 or N/O

See Page 158 for Legend of Terms and tolerances  
See Page 138 for Logic & BCD Truth Table

**FRONT VIEW**

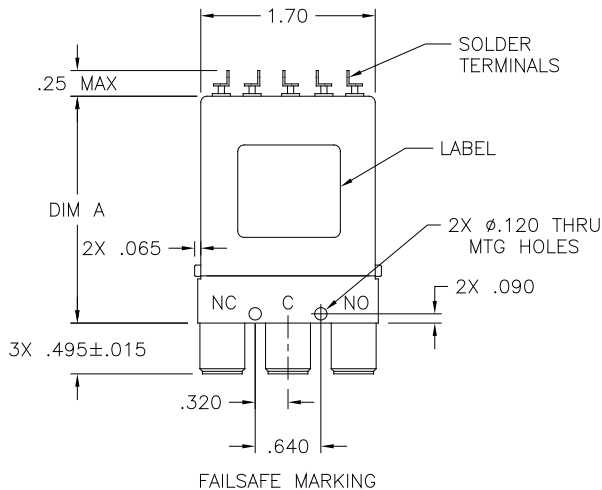

AVAILABLE OPTIONS*	OUTLINE DRAWING DIMENSION "A"
A, B, C, D	1.71
E, EH, F, FH	1.96
J, JH, K, KH	2.46
G, H, V, W	1.96
T, U	1.71

\* Consult factory for Dimension "A" when multi-pin connector is desired.

**BOTTOM VIEW**

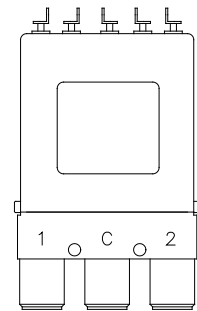
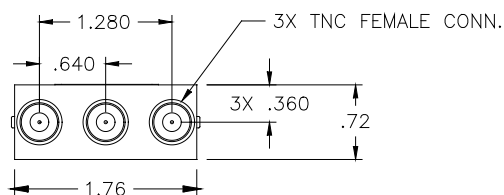

LATCHING MARKING