

4

3

2

1

REVISIONS				
ZONE	LTR	DESCRIPTION	DATE	APPROVED
A		RELEASE FOR PRODUCTION	9/24/80	KW
B		REV PER ECO 32972	2/5/81	RMC KW

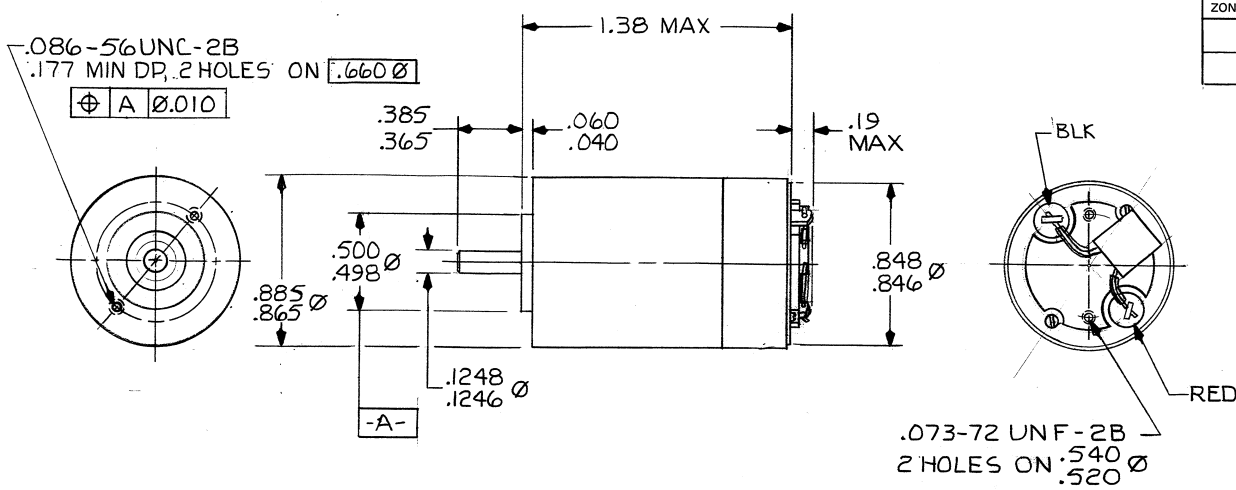

VDC	TORQUE, IN-OZ		RPM			AMPS	
	MIN	NOM	MIN	NOM	MAX	NOM	MAX
24	NO LOAD		11,000	12,000	13,000		.12
24		.22	9,500		11,500		.25
24	1.6		STALL				1.50
18	.20	.24	7,000				
32	.20	.24			16,000		

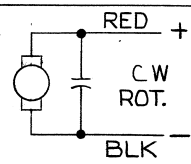

RED +

C W ROT.

BLK -

2. MAXIMUM UNIT WEIGHT: 2.0 OZ.

1. OPERATING TEMPERATURE RANGE: -55°C TO 85°C.

NOTES: UNLESS OTHERWISE SPECIFIED

QTY REQD	SYM	NOMENCLATURE OR DESCRIPTION	CODE IDENT NO.	PART OR IDENTIFYING NO.	SPECIFICATION	MATERIAL OR NOTE	ZONE	ITEM NO.
LIST OF MATERIAL								
UNLESS OTHERWISE SPECIFIED DIMENSIONS ARE IN INCHES				DRAWN DBG		DATE 9/17/80		
TOLERANCES: FRACTIONS DECIMALS ANGLES				CHECK RMC		DATE 7/23/80		
± — .XX ± .01 ± —				ENGINEER <i>[Signature]</i>		DATE 9/23/80		
.XXX ± .005				APPROVED <i>[Signature]</i>		DATE 9/23/80		
✓ ALL MACHINED SURFACES REF. USAS B46.1				APPROVED <i>[Signature]</i>		DATE 9/24/80		
MATERIAL:				APPROVED <i>[Signature]</i>		DATE 9/23/80		
FINISH: PER MIL-C-5541				APPROVED <i>[Signature]</i>		DATE 9/23/80		
9DC3		9DA69		SIZE C		CODE IDENT NO. 89321		DWG NO. 9DA69
NEXT ASSY		USED ON		SCALE 2/1		SHEET 1 OF 1		REV B
APPLICATION		QTY REQD		REPLACES		W.O. NO. 56513-01		

AEI AMERICAN ELECTRONICS, INC.
1600 E. VALENCIA DRIVE, FULLERTON, CALIF.

D C MOTOR

SIMILAR TO

REPLACES

W.O. NO.

56513-01

9DA69 B